

IV/144e



BIZERBA | METAL DETECTOR

VARIC SA



→ STAINLESS STEEL CONSTRUCTION
FOR STRICT HYGIENIC REQUIREMENTS AS PER
HACCP, IFS, GMP AND ISO 9000.



OPTIMIZE RELIABLY WITH VARIC SA

USER AND MACHINE PROTECTION

→ Prevent production breakdowns and machine damage

Safety in industrial production as well as user protection are an important concern worldwide, and are closely watched completely openly.

Even minor public complaints about quality and health risks can result in catastrophic consequences for a company. Negative publicity still has a serious effect on sales and market share years after a scandal.

Statutory provisions, standards and quality management systems such as HACCP, IFS, GMP, ISO 9000 and product liability force this trend.

With Bizerba metal detectors you prevent product deficiencies through metallic contamination thus minimizing your business risk.

The positive side-effect: You achieve large-

scale competitive and market shares through thorough checking and tracking of the quality of your processes and products.

→ For the highest process safety and perfect products

The VARIC SA metal detector rapidly and reliably detects all ferrous and non-ferrous metals in packaged and unpackaged piece goods.

For the automatic sorting of metal-containing packages the separating system pusher with ejection container is optionally available. The packages are ejected on the operator side.

Other optional accessories such as signal lamps and acoustic alarm signals complete the range.

The advantages:

- Stainless steel construction for strict hygienic requirements

	Conveyor belt width		Available clearance		Tunnel metal detector Type GLS	Key sensitivity ¹⁾	
	CBW		width/height CH			Ø Fe-ball	Ø V2A ball
Size I belt length: 1000/1500 mm	200 (7.9")	200/50±25	(7.9"/2"±0.98")		250/100 (9.8"/3.9")	0,54 (0.02")	0,76 (0.02")
	200 (7.9")	200/100±25	(7.9"/3.9"±0.98")		250/150 (9.8"/5.9")	0,74 (0.02")	1,04 (0.04")
	200 (7.9")	200/150±25	(7.9"/5.9"±0.98")		250/200 (9.8"/7.9")	0,94 (0.03")	1,32 (0.05")
	200 (7.9")	200/200±25	(7.9"/7.9"±0.98")		250/250 (9.8"/9.8")	1,14 (0.04")	1,60 (0.06")
	300 (11.8")	300/50±25	(11.8"/2"±0.98")		350/100 (13.8"/3.9")	0,60 (0.02")	0,84 (0.03")
	300 (11.8")	300/100±25	(11.8"/3.9"±0.98")		350/150 (13.8"/5.9")	0,80 (0.03")	1,12 (0.04")
	300 (11.8")	300/150±25	(11.8"/5.9"±0.98")		350/200 (13.8"/7.9")	1,00 (0.03")	1,40 (0.05")
	300 (11.8")	300/200±25	(11.8"/7.9"±0.98")		350/250 (13.8"/9.8")	1,20 (0.04")	1,68 (0.06")
Size II belt length: 1300/2000 mm	400 (15.7")	400/100±25	(15.7"/3.9"±0.98")		500/150 (19.7"/5.9")	0,88 (0.03")	1,23 (0.04")
	400 (15.7")	400/150±25	(15.7"/5.9"±0.98")		500/200 (19.7"/7.9")	1,08 (0.04")	1,51 (0.05")
	400 (15.7")	400/200±25	(15.7"/7.9"±0.98")		500/250 (19.7"/9.8")	1,28 (0.05")	1,79 (0.07")
	400 (15.7")	400/250±25	(15.7"/9.8"±0.98")		500/300 (19.7"/11.8")	1,48 (0.05")	2,07 (0.08")
	500 (19.7")	500/100±25	(19.7"/3.9"±0.98")		600/150 (23.6"/5.9")	0,94 (0.03")	1,31 (0.05")
	500 (19.7")	500/150±25	(19.7"/5.9"±0.98")		600/200 (23.6"/7.9")	1,14 (0.04")	1,59 (0.06")
	500 (19.7")	500/200±25	(19.7"/7.9"±0.98")		600/250 (23.6"/9.8")	1,34 (0.05")	1,87 (0.07")
	500 (19.7")	500/250±25	(19.7"/9.8"±0.98")		600/300 (23.6"/11.8")	1,54 (0.06")	2,05 (0.08")

Dimensions in mm (inches)

**** IN THIS WAY YOU FULFIL THE EXPECTATIONS OF YOUR CLIENTS ABOUT THE QUALITY OF YOUR PRODUCTS.**

¹⁾ → **Key sensitivity:** The basic sensitivity refers to the center of the detection coil aperture. The achievable sensitivity in the product depends on its product effect, the temperature of the material to be investigated plus influences at the device location.



→ HEIGHT-ADJUSTABLE CONVEYOR BELT

- Open, easily accessible design for optimum, simple cleaning
- Highest sensitivity and selectivity for all metals
- Multifrequency technology for particularly conductive products and packages
- Robust conveyor belt construction in stainless steel for maximum search sensitivity in prolonged operation reduces the TCO
- Flexible conveyor belt adaptation to product-specific circumstances

- Modern microprocessor technology with self-monitoring, self-calibration and temperature compensation constantly checks all components and reliably identifies sources of error
- Product effect compensation with automatic learning guarantees optimum working point
- Multiproduct memory simplifies metal detector setting up and optimizes the overall performance of the system
- Simple operation on the straightforward graphic display
- Password protection for data safety and system operation protection
- Design complies with current accident prevention regulations
- Future-proof by modular construction and scalability

Special designs are available on request for use in wet areas.



→ OPTION: SEPARATING SYSTEM WITH EJECTION CONTAINER

TECHNICAL DATA



- **Maximum product size:** Width = conveyor belt width (CBW)
Height = available clearance height (CH)
-25 mm (depending on product effect)
Length = approx. conveyor belt length

- **Maximum load:** Size 1: 10 kg/22 lbs;
Size 2: 15-25 kg/33-55 lbs

- **Product properties:** Possibly existing product effect compensatable

- **Product temperature:** -20 °C to +80 °C/-4 °F to 176 °F

- **Ambient temperature:** -10 °C to +40 °C/14 °F to 104 °F
(other temperatures on request)

- **Mechanics version:** conveyor belt and metal detector; Stainless steel 1.4301 (AISI 304); fixed glass-beaded frame construction with four height-adjustable feet and fastening drill holes; 1.4301 (AISI 304) stainless steel; glass-beaded drive, guide and tightening rollers; 1.4301 (AISI 304) stainless steel. Drive through drum-integrated motor with fixed speeds and automatic thermal contact monitoring. Sliding plate for the belt made of low-wear and coated melamine resin plate conveyor belt made of white FDA quality polyester (PES) • Conveying side made of polyurethane (PUR) • Running side made of impregnated polyester fabric
Operating side on right in conveying direction

- **Roll diameter:** Size 1: 32 mm (1.25"); Size 2: 80 mm (3.14")

- **Conveyor belt and belt lengths:** Size 1: 200 mm (7.9"), 300 mm (11.8") each with belt length 1000 mm (39.4") or 1500 mm (59")
Size 2: 400 mm (15.7"), 500 mm (19.7") each with belt length 1300 mm (51.2") or 2000 mm (78.7")

- **Dimensions in mm (inches):** Dimensions see also table on inside

→ **Basic version Size I**

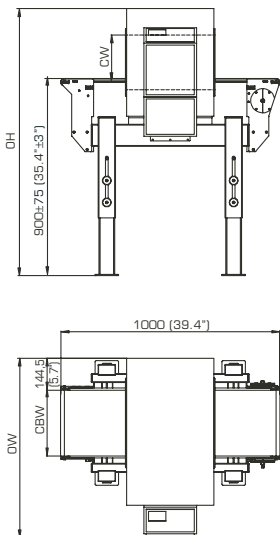

→ **Basic version Size II**

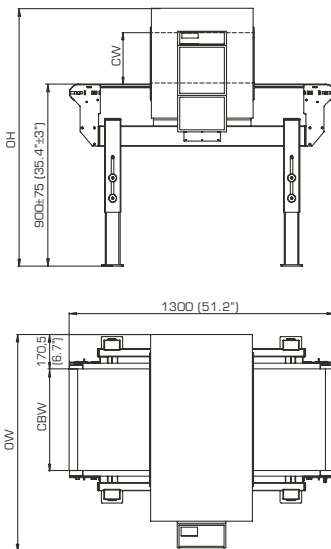

- **Transport direction** left/right; right/left

- **Electrics:** Combined control and operating unit for conveyor belt and metal detector; factory-set with metal detection belt stop; cabling in the frame as far as possible; On/Off switch; Emergency Stop switch

- **Operating voltage:** 230/115 VAC (± 10%); 120 V/60 Hz
50/60 Hz single-phase, approx. 400 mA

- **Protection type:** IP 65 (jet-proof), NEMA 4

- **Conveyor belt speeds:** 0.1 m/sec; 0.2 m/sec; 0.3 m/sec; 0.4 m/sec; 0.5 m/sec; 0.6 m/sec; 0.8 m/sec; 1.0 m/sec; variable belt speed (-50% to +30%) optional

→ **Size I with pusher and collecting bin**

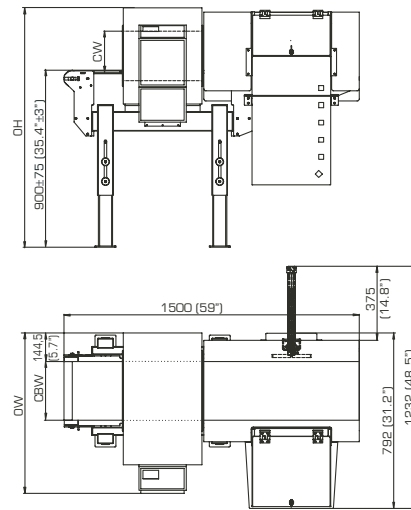

→ **Size II with pusher and collecting bin**

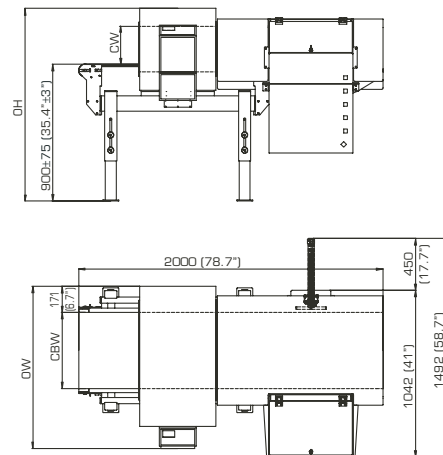

CW clearance width
CBW conveyor belt width
OH overall height
OW overall width



BIZERBA

_balanced information